

## Float valves

### AK with ball horizontal

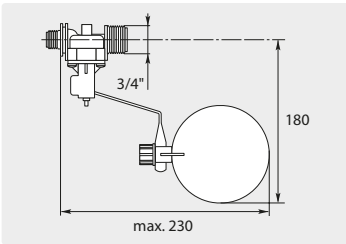

Plastic. Pressure 0.3 - 10 bar.  
Max. 22 l/min / 60 °C

R+M Nr.	↻	↺	⊙
701 402	3/4" M	3/4" M	10 mm

### AK with ball vertical

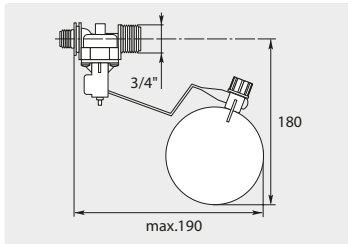

Plastic. Pressure 0.3 - 10 bar.  
Max. 22 l/min / 60 °C

R+M Nr.	↻	↺	⊙
701 404	3/8" M	3/4" M	10 mm

### AK with PE float

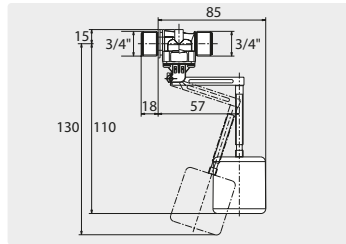

PE float. Pressure 0.3 - 10 bar.  
Max. 22 l/min / 60 °C

R+M Nr.	↻	↺	⊙
701 405	3/4" M	3/4" M	10 mm

### AK with PE float

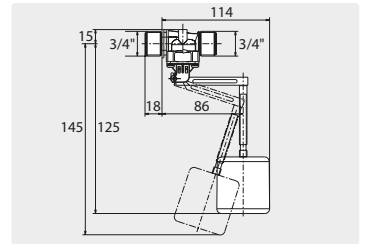

PE float. Pressure 0.3 - 10 bar.  
Max. 22 l/min / 60 °C

R+M Nr.	↻	↺	⊙
701 408	3/4" M	3/4" M	10 mm

### AK with ball

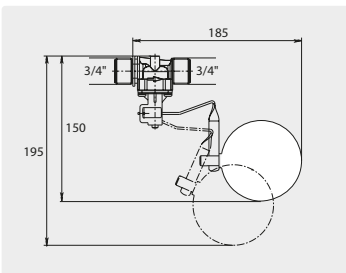

Plastic. Pressure 0.3 - 10 bar.  
Max. 22 l/min / 60 °C

R+M Nr.	↻	↺	⊙
701 403	3/4" M	3/4" M	10 mm

### Accessories AK



Ball

R+M Nr.  
701 43

Membrane

R+M Nr.  
701 42

### Accessories AK valves



Clamp

R+M Nr.  
701 41

Hose tail DN 13 mm

R+M Nr.  
711 60 3/4" F

### ST-8 with ball

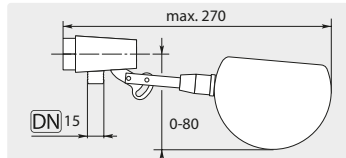

Brass / plastic.  
Max. 10 bar / 22 l/min / 60 °C

R+M Nr.	↻	⊙
200 008 520	1/2" F	12 mm

### Ball ST-8



R+M Nr.	TYP
030 000 180	swimmer
020 000 610	screw

### Plastic



Brass / plastic. 3/4" M.  
DN 9.5. Max. 60 °C

R+M Nr.
701 500 100

### PEKI without ball

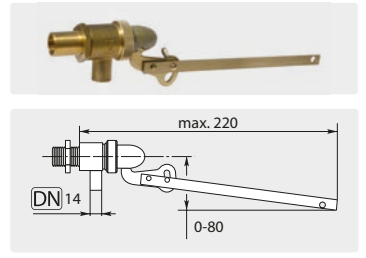

3/8" M. Brass. Max. 10 bar / 85 °C

R+M Nr.	↻	⊙
701 00	16 l/min	8 mm
701 05	30 l/min	12 mm

### Ball PEKI



Max. 60 °C

R+M Nr.
701 35



Stainless steel. 85 °C. Suitable for 701 05

R+M Nr.
701 39

### Seal kit PEKI



R+M Nr.
701 001

### Level sensor LS809-51



Plastic. Cable length 500 mm. 2-core cable. 250 V / 1 A / 70 W. -30 °C - +105 °C

R+M Nr.
701 880 951