



Motor protection switches  
 Ravel motors  
 Remote thermometers  
 Remote thermostats  
 Time hour meter

82  
 83  
 82  
 82  
 82

**Motor protection switches**

**Type OKN**



K F

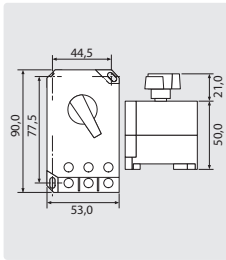

Housing for type OKN

R+M Nr.	working range
901 516	10.0 - 16.0 A
901 522	16.0 - 22.0 A
901 527	22.0 - 27.0 A

R+M Nr.	M
901 540	plastic

**Time hour meter**



cutout

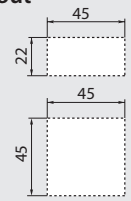

Meter with clip

R+M Nr.	V
915 102 4	24 V ~
915 122 0	230 V ~
915 140 0	400 V ~

**Remote thermometers**

With contact probe and adjustable knob

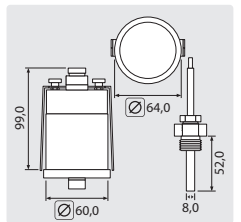

1/2" M. Contact 5 A - 250 V (AC1). Indication of temperature 0 - 120 °C

R+M Nr.	working range	tube length
910 20	0 - 80 °C	1,000 mm

**Type WIMEX**

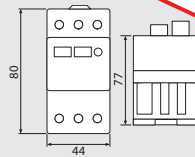

new



new

Housing for type WIMEX, IP55

R+M Nr.	working range
901 710	6.3 - 10.0 A
901 716	10.0 - 16.0 A
901 720	16.0 - 20.0 A
901 725	20.0 - 25.0 A

R+M Nr.	M
901 730	plastic

**Remote thermostats**

**Emerson 1536**

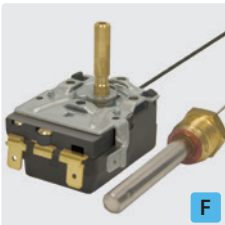

F

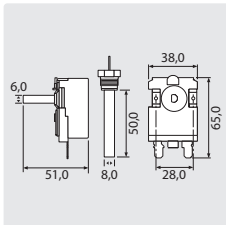

M14 x 1 M. Contact 16 A - 380 V (AC1)

R+M Nr.	working range	tube length
910 16	0 - 160 °C	1,550 mm

**Probe with screw**

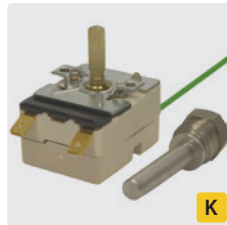

K

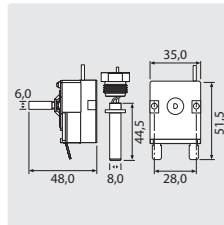

3/8" M. Contact 16 A - 380 V (AC1)

R+M Nr.	working range	tube length
910 12	30 - 150 °C	1,520 mm
910 13	0 - 152 °C	920 mm

**Emerson 8654**



W

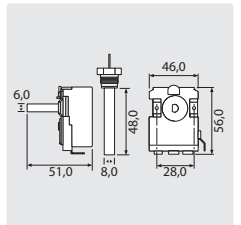

3/8" M. Contact 16 A - 380 V (AC1)

R+M Nr.	working range	tube length
910 15	30 - 150 °C	1,550 mm

## Ravel motors

### Motor with hollow shaft

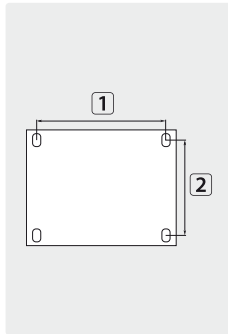

IP54. 1,400 r.p.m.

R+M Nr.	∅	hole size 1 x 2	TYP	V	A	KW
175 001 061	24	140 x 160 mm	H100	400	6,9	3
175 001 081	24	140 x 190 mm	H112	400	9,4	4
175 001 090	24	140 x 190 mm	H112	400	12,1	5,5
175 001 120	24	140 x 216 mm	H132S	400	15,4	7,5
175 001 143	24	178 x 216 mm	H132M	400	21,3	11

### Motor with solid shaft

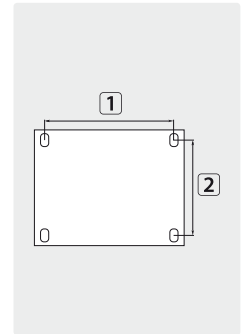

IP54. 1,400 r.p.m.

R+M Nr.	∅	hole size 1 x 2	TYP	V	A	KW
175 002 004	28	140 x 160 mm	H100	400	5,1	2,2
175 002 001	28	140 x 190 mm	H112	400	9,4	4
175 002 002	28	140 x 190 mm	H112	400	12,6	5,5
175 002 091	38	140 x 216 mm	B3 132S	400	16,8	7,5
175 002 087	38	210 x 254 mm	B3 160M	400	29	15

### Flange for hollow shaft motor

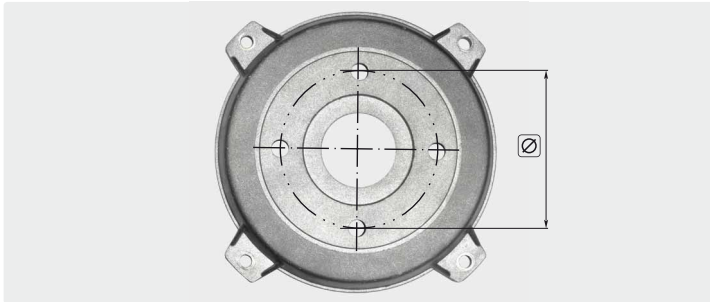

R+M Nr.	TYP	bolt-circle ∅
175 300 306 1	H 100	75 mm
175 300 307 4	H 112	75 mm
175 300 305 1	H 100	87 mm
175 300 305 2	H 112	87 mm

Further versions of Ravel motors are available on request!

### Motors with internal flexible joint RVJ Series

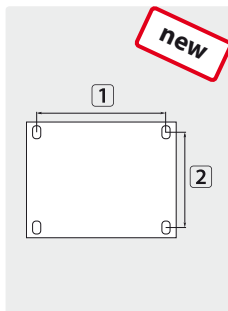
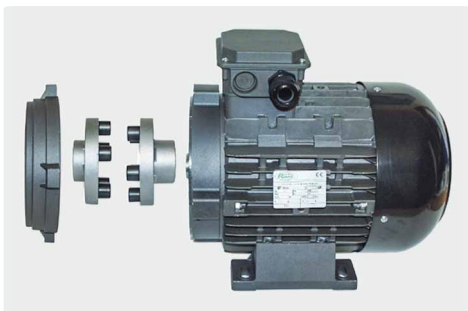

IP54. 1,400 r.p.m.

R+M Nr.	∅	hole size 1 x 2	TYP	V	A	KW
175 002 400	24	140 x 216 mm	H132S	400	15,4	7,5
175 002 401	24	178 x 216 mm	H132M	400	21,3	11
175 002 402	24	178 x 216 mm	H132M	400	17,8	9,2
175 002 570	24	140 x 216 mm	H112	400	12,1	5,5

Pump/motor assignment on page 42

## Motor control easywash365+



Motor control for the operation of motors with 4 - 7.5 kW power at 400 VAC, 50 Hz, IP 65. RAL 7035.

H x W x D 380 x 380 x 210 mm.

Supply: 400VAC, 50Hz, 3Ph / N / PE with main switch (cam switch) 25A. Control voltage conditioning 24VDC, 2.5A with backup fuse 2A.

Motor outlet with power contactor 7.5kW and wide-range motor protection switch 8-32A.

LOGO small control unit.

1 operating hours counter (IP 65) and 2 command and signaling devices built into the door

R+M Nr.	☒
920 001 380	14 kg

## Coin box easywash365+ including control box

## Coin box easywash365+ including control box



R+M coin box, mechanical, feat. money return, incl. control box, IP 66, RAL 7035 feat. 2 m supply cable with CEE-plug, 16 A, 400 VAC, 50 Hz, 3 PH/N/PE. Control voltage processing 24 VAC, 20 VA with 2 automatic circuit breakers. Motor output with power contactor 7.5 kW, wired to CEE add-on box. Feat. a time relay for pulse stretching 0.05 s - 10 h. Excl. control cable

R+M Nr.	money	coin box	control box
925 513 803	chip (profiled)	260 x 160 x 110	300 x 300 x 155
925 513 805	50 Cent	260 x 160 x 110	300 x 300 x 155
925 513 801	1 €	260 x 160 x 110	300 x 300 x 155
925 513 802	2 €	260 x 160 x 110	300 x 300 x 155

## Control cable



5 wires, UV-resistant. Sold by metre.

R+M Nr.	☒
925 510 001	5 G 1.5 mm <sup>2</sup>

## Control box easywash365+



Control box, IP 66, RAL 7035. H x W x D 300 x 300 s 155 mm. Feat. 2 m supply cable with CEE-plug 16 A, 400 VAC, 50 Hz, 3 Ph/N/PE.

Control voltage processing 24 VAC, 20 VA with 2 automatic circuit breakers.

Motor output with power contactor 7.5 kW, wired to CEE add-on box.

Feat. a time relay for pulse stretching 0.05 s - 10 h.

Excl. control cable

R+M Nr.	☒
925 510 000	9,6 kg

## CEE Plug

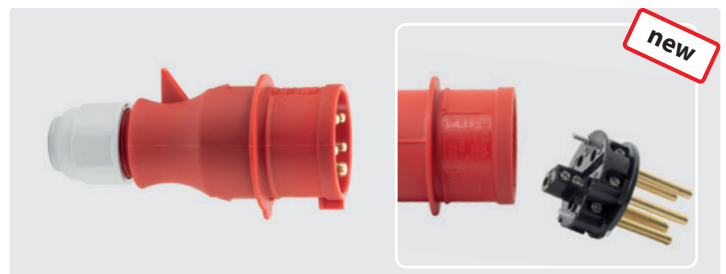

400V / 16A / 3PNE. IP 44. With screw terminals up to a maximum of 2.5 mm<sup>2</sup>

R+M Nr.	
901 338 001	

Symbols ☒ material ☒ length ☒ temperature ☒ diameter ☒ type ☒ weight