

Ultra high pressure ball valves ST-3105

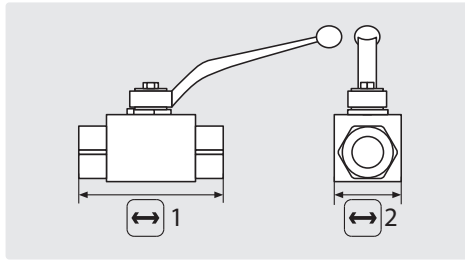

Stainless steel V4A / AISI 316 Ti. Ball stainless steel.
Max. 500 bar / 80 °C

R+M Nr.	↔ 1	↔ 2	⊙
707 15	69 mm	26 mm	1/4" F
707 25	72 mm	32 mm	3/8" F
707 35	83 mm	35 mm	1/2" F

Sewer cleaning nozzles

Rotating nozzles RT . 1,000 bar

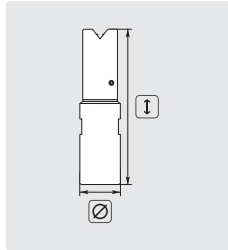

1/8" F. Side jet 2. Front jet 2. Stainless steel.
Rotating body hp-bronze. Compact model,
universally applicable. Extreme cleaning
performance, removes hard deposits. **1** 80 mm.
⊙ 12 mm. Weight 0.18 kg.
Max. 1,000 bar

R+M Nr.	↔
652 710 006	6 l / 100 bar
652 710 012	12 l / 100 bar
652 710 014	14 l / 100 bar

Rotating nozzles RH . 1,000 bar

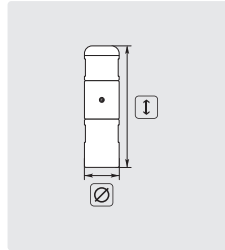

1/8" F. Side jet 2. Stainless steel. Rotating
body hp-bronze. Compact model, universally
applicable. Extreme cleaning performance,
removes hard deposits. **1** 63 mm. ⊙ 12 mm.
Weight 0.18 kg.
Max. 1,000 bar

R+M Nr.	↔
652 810 006	6 l / 100 bar
652 810 010	10 l / 100 bar
652 810 014	14 l / 100 bar

Nozzles for sewer cleaning

Suttner nozzles for sewer cleaning ST-49.3



1/8" F. Nozzle with traction. Stainless steel.
Hardened stainless steel body. Compact model,
universally applicable. Extreme cleaning
performance.
⊙ 12 mm.
Max. 500 bar

R+M Nr.	⊙
200 049 950	05
200 049 970	07

Symbols ↔ length **1** height ⊙ thread ↔ flow °C temperature ⊙ nozzle ⊙ diameter