

## Suttner spray guns

ST-2320



Professional gun. Application, e.g. in foam and rinsing applications in the food industry. Stainless steel/brass. Valve piston made of stainless steel. PEEK seat. EPDM seal. Max. 150 bar / 80 l/min. / 150 °C

R+M Nr.		
202 320 565	1/2" F	1/2" F swivel.

ST-2320 with coupling ST-3100



Professional gun with coupling ST-3100. Application, e.g. in foam and rinsing applications in the food industry. Stainless steel/brass. Valve piston made of stainless steel. PEEK seat. EPDM seal. Max. 150 bar / 80 l/min. / 150 °C

R+M Nr.		
202 320 566	coupling ST-3100	1/2" F swivel

ST-2320 with adjustable nozzle ST-51.1



Professional gun with adjustable nozzle ST-51.1. Application, e.g. in foam and rinsing applications in the food industry. Stainless steel/brass. Valve piston made of stainless steel. PEEK seat. EPDM seal. Max. 150 bar / 80 l/min. / 150 °C

R+M Nr.		
202 320 567	nozzle ST-51.1	1/2" F swivel

Repair kit ST-2320

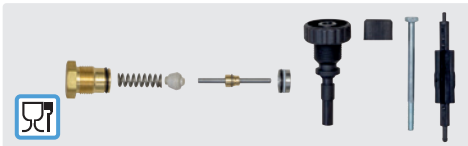

R+M Nr.
202 320 495

How the ST-2320 works with the adjustable nozzle ST-51.1



Long-range pencil jet



Conical spray jet



Made out of plastics intended to come into contact with food-stuffs according to Regulation (EC) No. 1935/2004. Especially designed for applications in the food industry.

